

# Advantage ICF System Design Manual

## 6 Inch ICF Wall to Footing Connection Detail

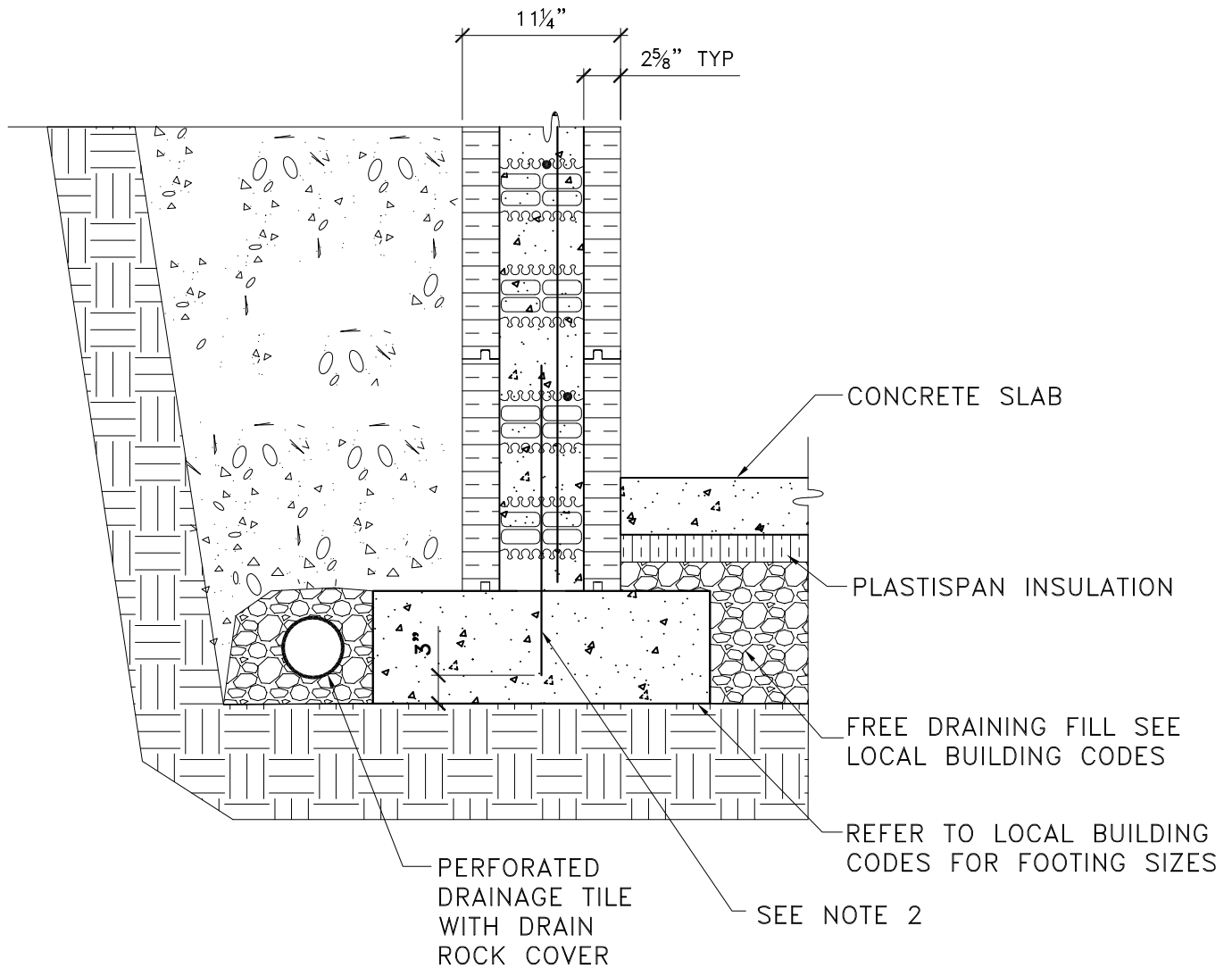

*Better building ideas from PFB* 



#### NOTES:

1. DETAIL TO BE USED IN CONJUNCTION WITH ADVANTAGE ICF SYSTEM TECHNICAL & INSTALLATION MANUAL.
2. DOWEL FROM FOOTING TO MATCH SIZE OF VERTICAL REBAR AT A MAXIMUM SPACING OF 24" O.C. WITH MINIMUM 8" TOTAL EMBEDMENT INTO FOOTING AND 3" COVER THICKNESS OR AS PER LOCAL CODE. IF FOOTING IS LESS THAN 11" THICK, USE "L" SHAPE DOWEL.

No.	REVISION DESCRIPTION	DATE	BY	CHKD	APPD



PLANT OR PROJECT		6" ADVANTAGE ICF SYSTEM		SCALE		NTS	
DESIGN		G DOREN		DATE		JULY, 09	
DRAWN		L XIE		DATE		JULY, 09	
CHECKED		J WHALEN		DATE		JULY, 09	
DRAWING No.		D.1.6		REV.			

## WALL TO FOOTING CONNECTION DETAIL