

# Advantage ICF System Design Manual

## 6 Inch ICF Knee or Pony Wall

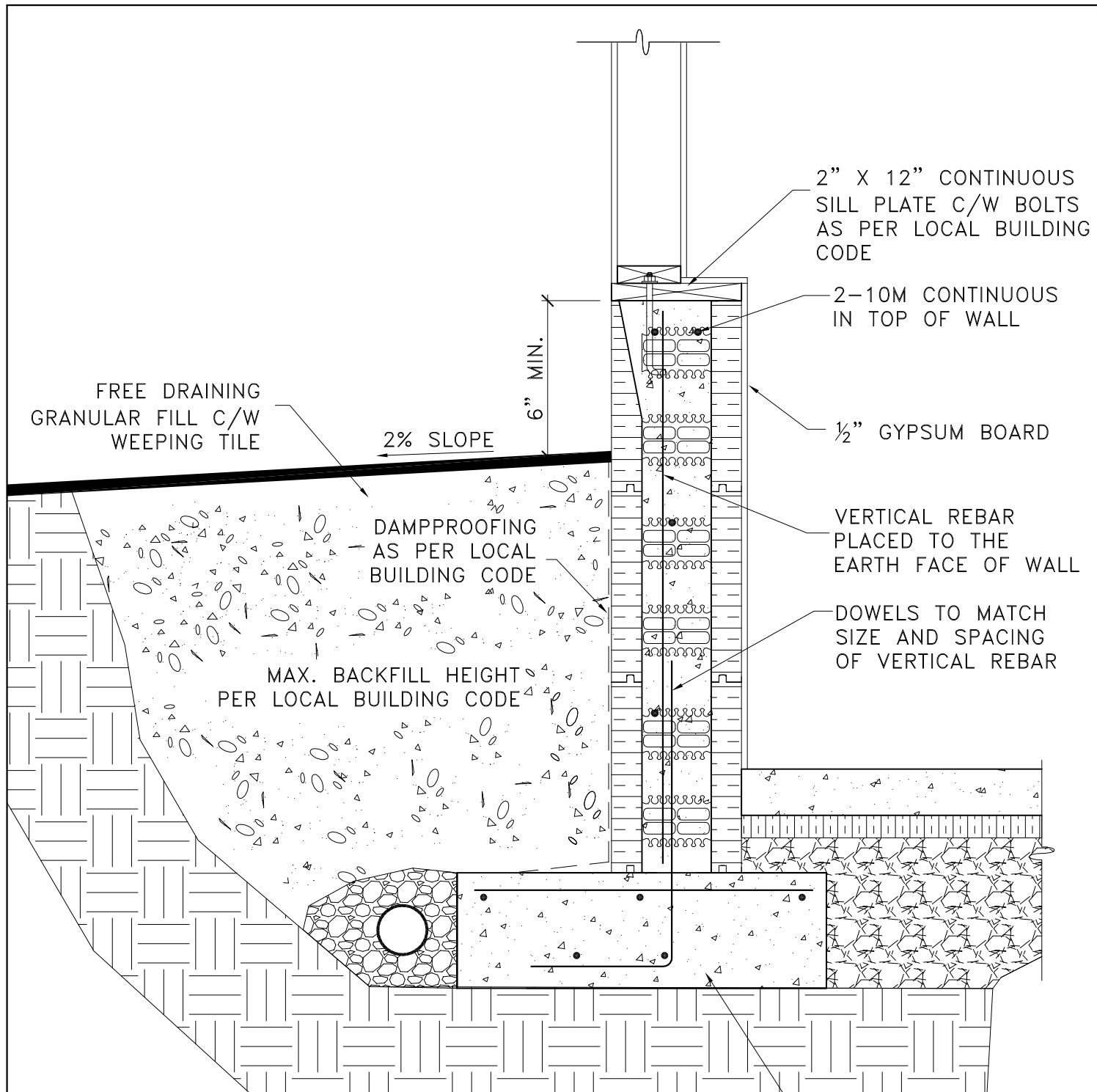

*Better building ideas from PFB* ™



#### NOTES:

1. ENSURE APPROPRIATE FROST COVER.
2. THIS IS A Laterally UNSUPPORTED WALL. REFER TO LOCAL BUILDING CODES.
3. DETAIL TO BE USED IN CONJUNCTION WITH ADVANTAGE ICF SYSTEM TECHNICAL & INSTALLATION MANUAL.
4. HORIZONTAL AND VERTICAL REBAR OVERLAP TO BE 450 mm (18") FOR 10M AND 650 mm (26") FOR 15M.

REFER TO LOCAL BUILDING CODES FOR FOOTING SIZES

No.	REVISION DESCRIPTION	DATE	BY	CHKD	APPD



PLANT OR PROJECT 6" ADVANTAGE ICF SYSTEM

KNEE OR PONY WALL

SCALE NTS

DESIGN G DOREN	DATE JULY, 09
DRAWN L XIE	DATE JULY, 09
CHECKED J WHALEN	DATE JULY, 09
DRAWING No.	REV.

S.1.6