

Advantage ICF System Design Manual

8 Inch ICF Wall to Footing Connection Detail

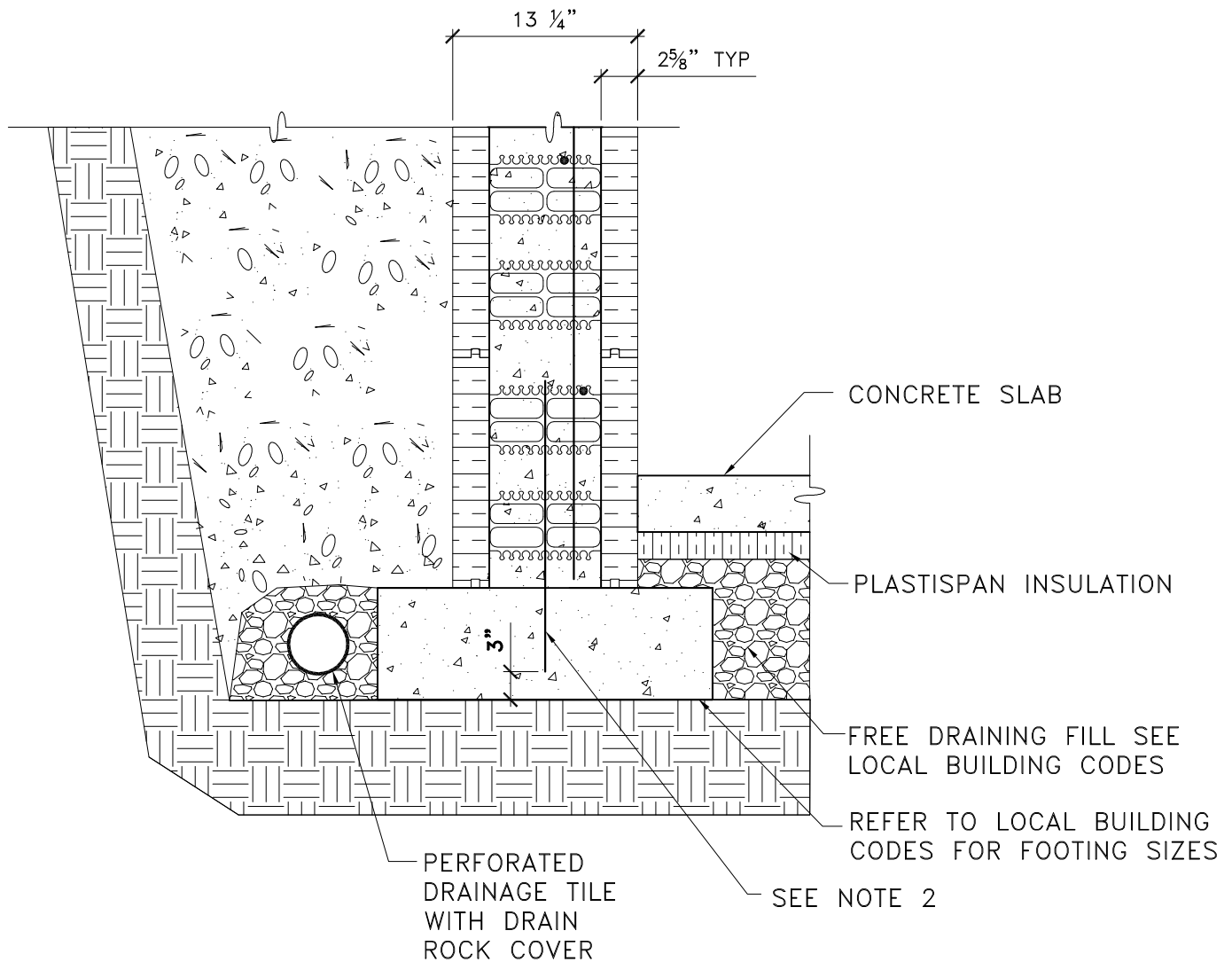

Better building ideas from PFB 



NOTES:

1. DETAIL TO BE USED IN CONJUNCTION WITH ADVANTAGE ICF SYSTEM TECHNICAL & INSTALLATION MANUAL.
2. DOWEL FROM FOOTING TO MATCH SIZE OF VERTICAL REBAR AT A MAXIMUM SPACING OF 24" O.C. WITH MINIMUM 8" TOTAL EMBEDMENT INTO FOOTING AND 3" COVER THICKNESS OR AS PER LOCAL CODE. IF FOOTING IS LESS THAN 11" THICK, USE "L" SHAPE DOWEL.

No.	REVISION DESCRIPTION	DATE	BY	CHKD	APPD



PLANT OR PROJECT 8" ADVANTAGE ICF SYSTEM

WALL TO FOOTING CONNECTION DETAIL

SCALE NTS

DESIGN G DOREN	DATE JULY, 09
DRAWN L XIE	DATE JULY, 09
CHECKED J WHALEN	DATE JULY, 09
DRAWING No.	REV.

D.1.8