

Advantage ICF System Design Manual

8 Inch ICF Foundation & Main Floor

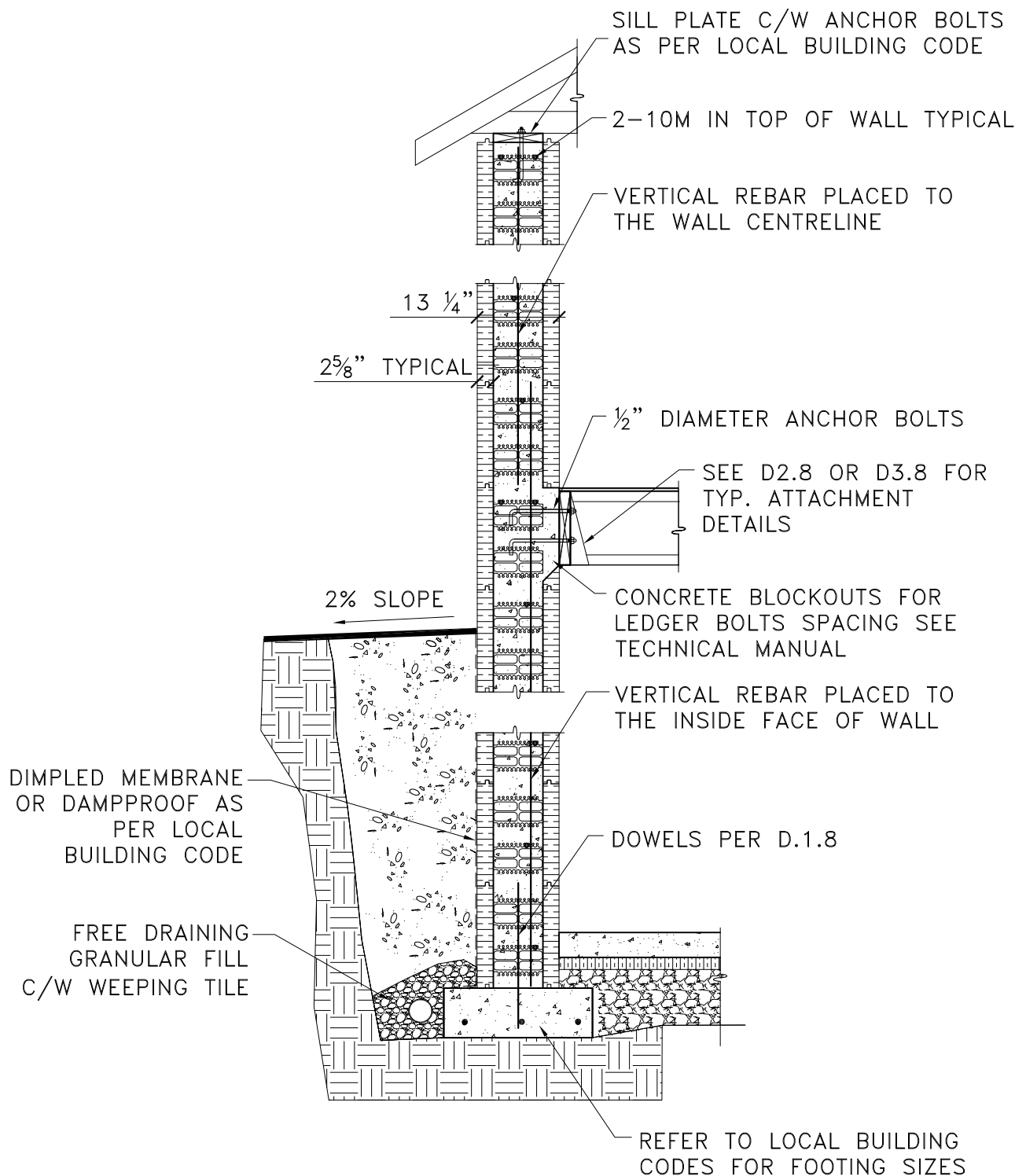

Better building ideas from PFB 



NOTES:

- 1. DETAIL TO BE USED IN CONJUNCTION WITH ADVANTAGE ICF SYSTEM TECHNICAL & INSTALLATION MANUAL.**
- 2. HORIZONTAL AND VERTICAL REBAR OVERLAP TO BE 450 mm (18") FOR 10M AND 650 mm (26") FOR 15M.**

| No. | REVISION DESCRIPTION | DATE | BY | CHKD | APPD |
|-----|----------------------|------|----|------|------|
| | | | | | |
| | | | | | |



PLANT OR
PROJECT 8" ADVANTAGE ICF SYSTEM

**FOUNDATION AND
MAIN FLOOR**

SCALE NTS

| | |
|---------------------|------------------|
| DESIGN G DOREN | DATE JULY, 09 |
| DRAWN L XIE | DATE JULY, 09 |
| CHECKED J WHALEN | DATE JULY, 09 |
| DRAWING No. | REV. |

S.2.8